

Schnitt G - G

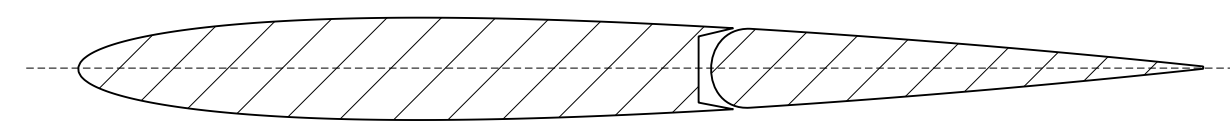

Schnitt J - J

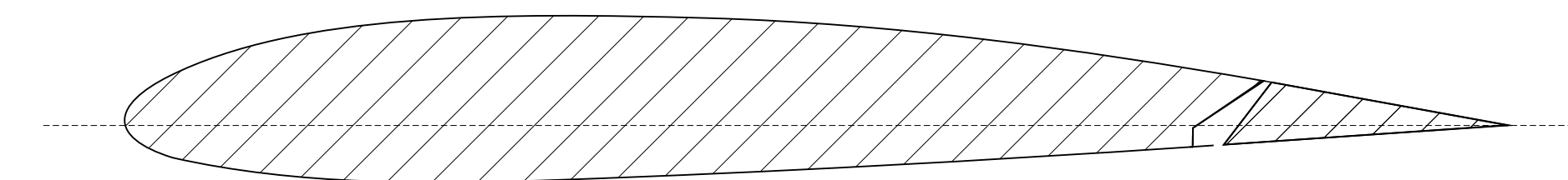

Querruderausschlag

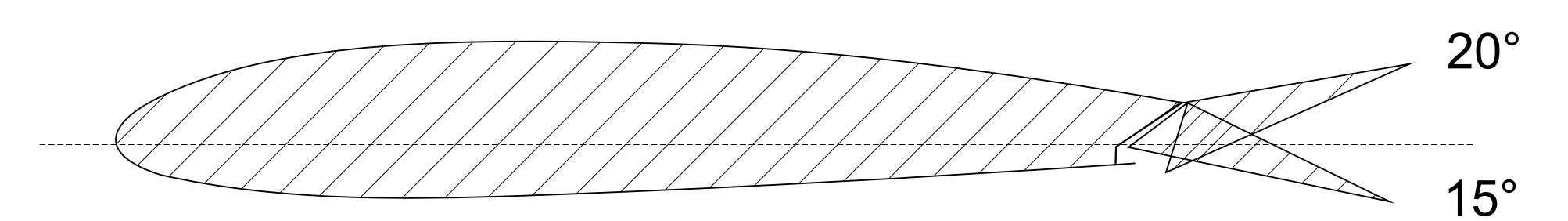

Schnitt H - H

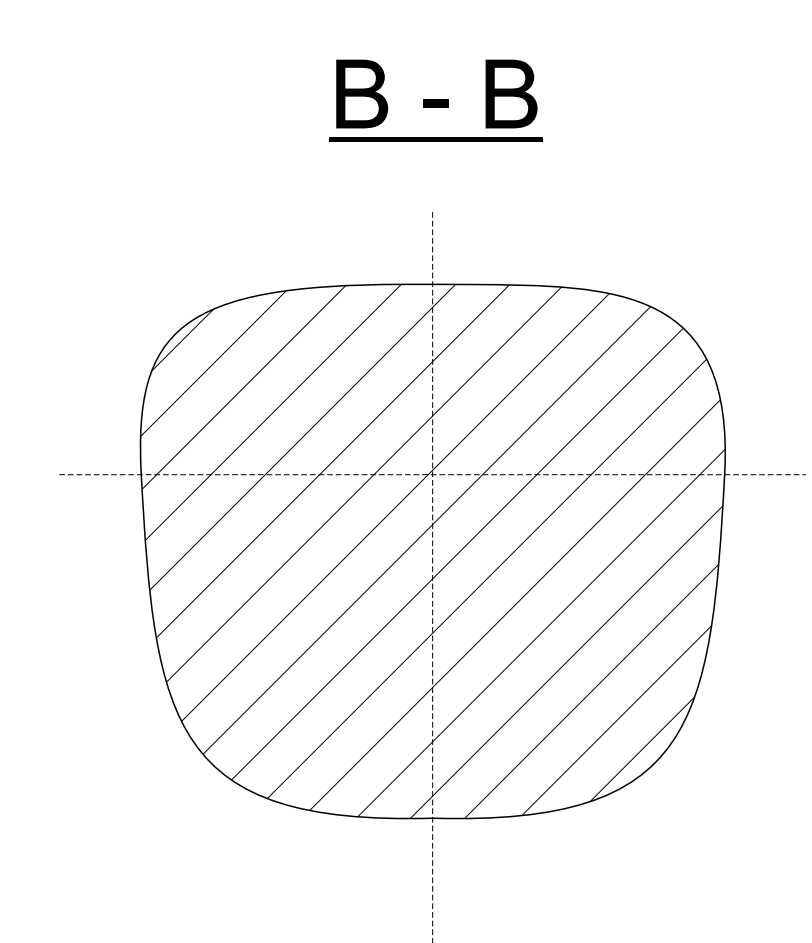
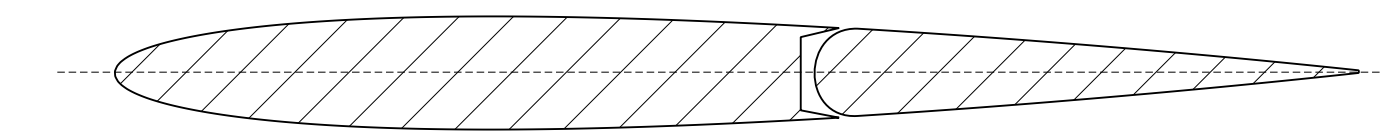

B - B

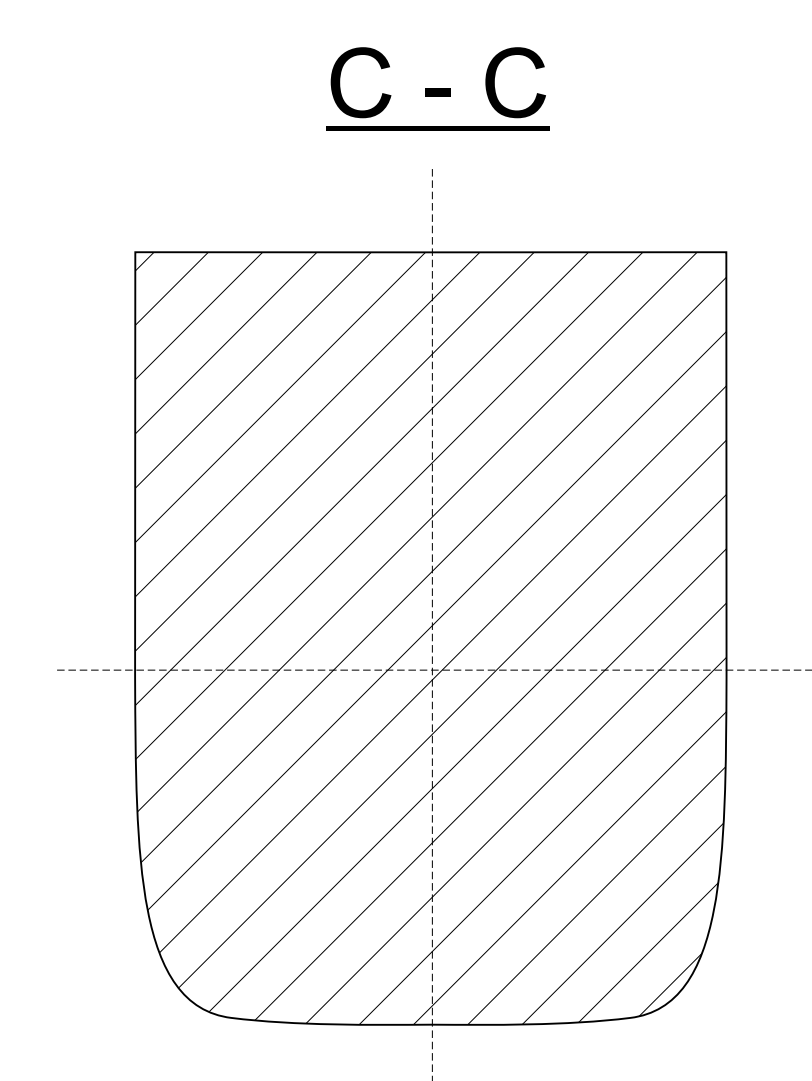

C - C

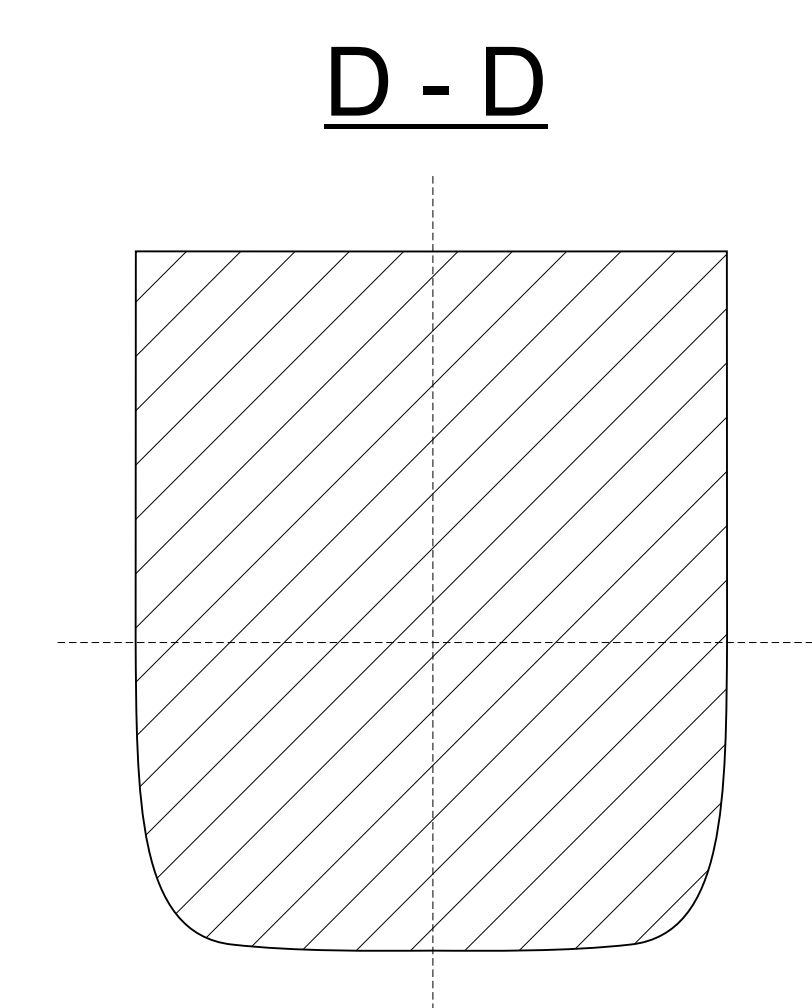

D - D

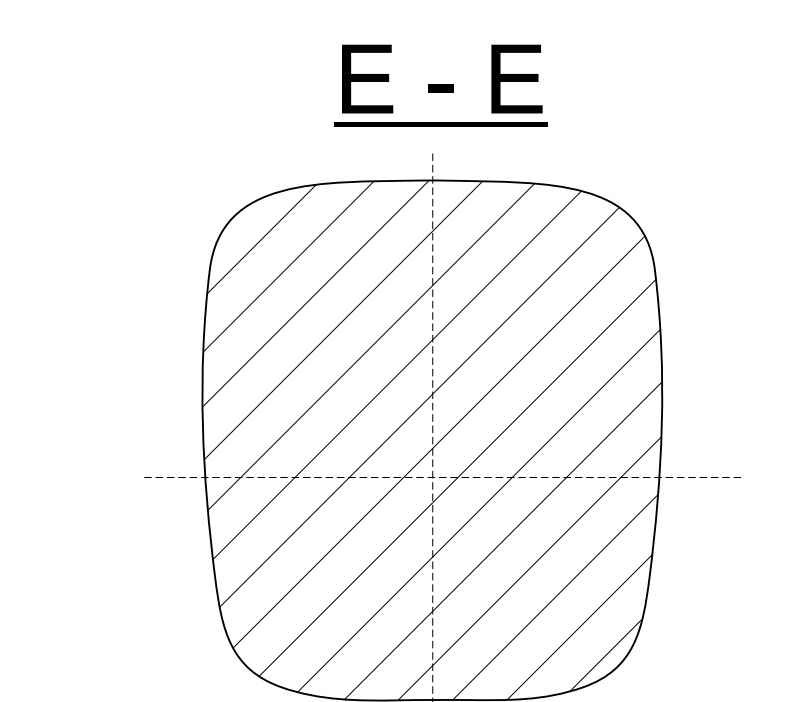

E - E

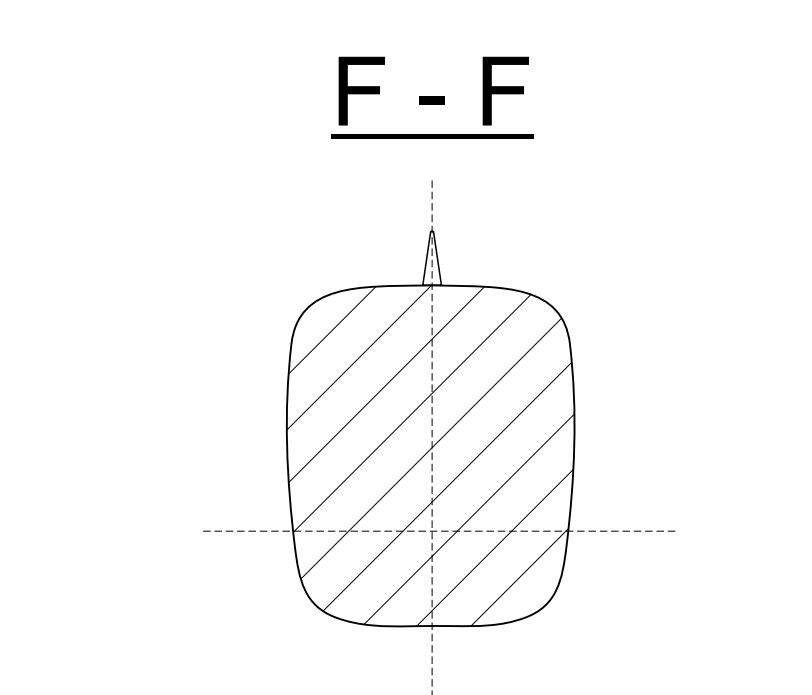

F - F

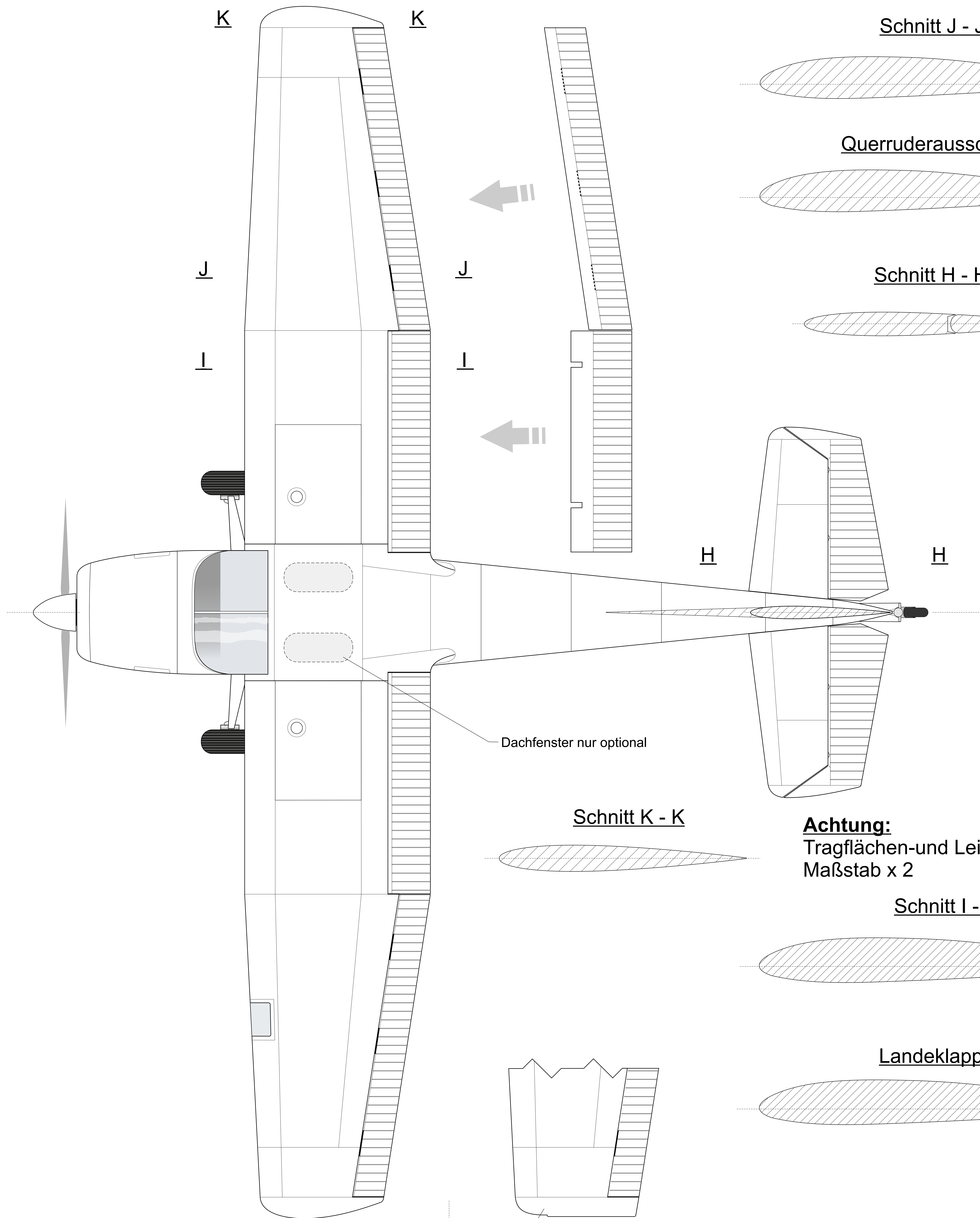

Schnitt K - K

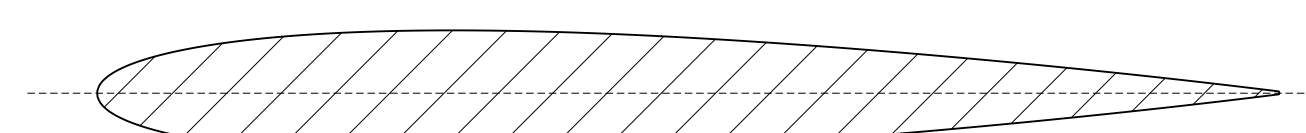

Achtung:
Tragflächen-und Leitwerksschnitte
Maßstab x 2

Schnitt I - I

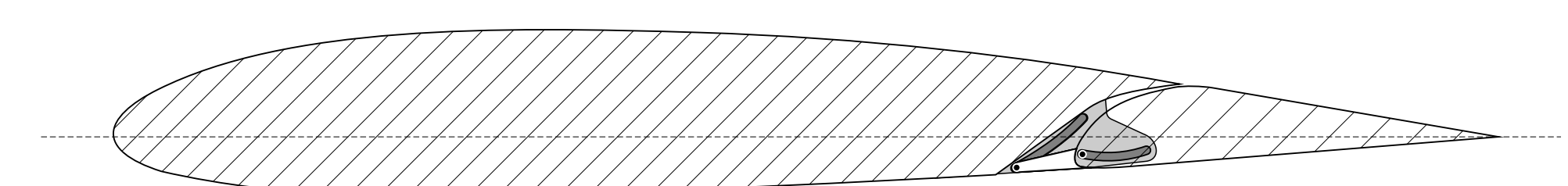

Landeklappen

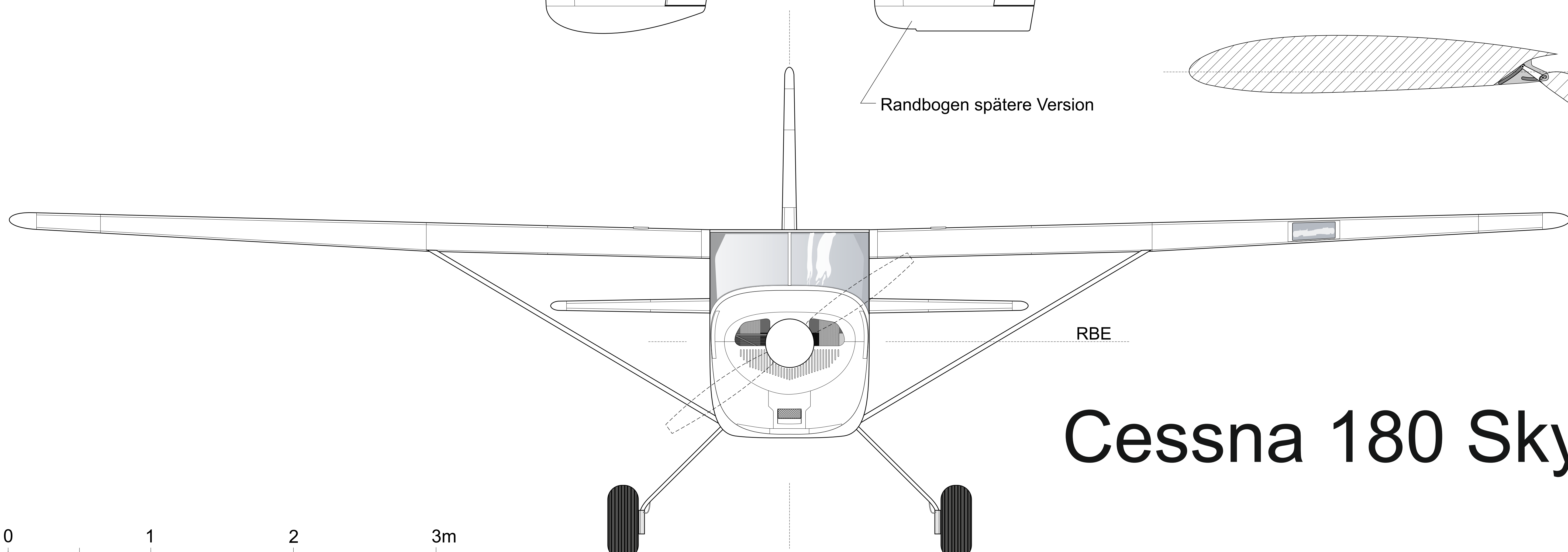
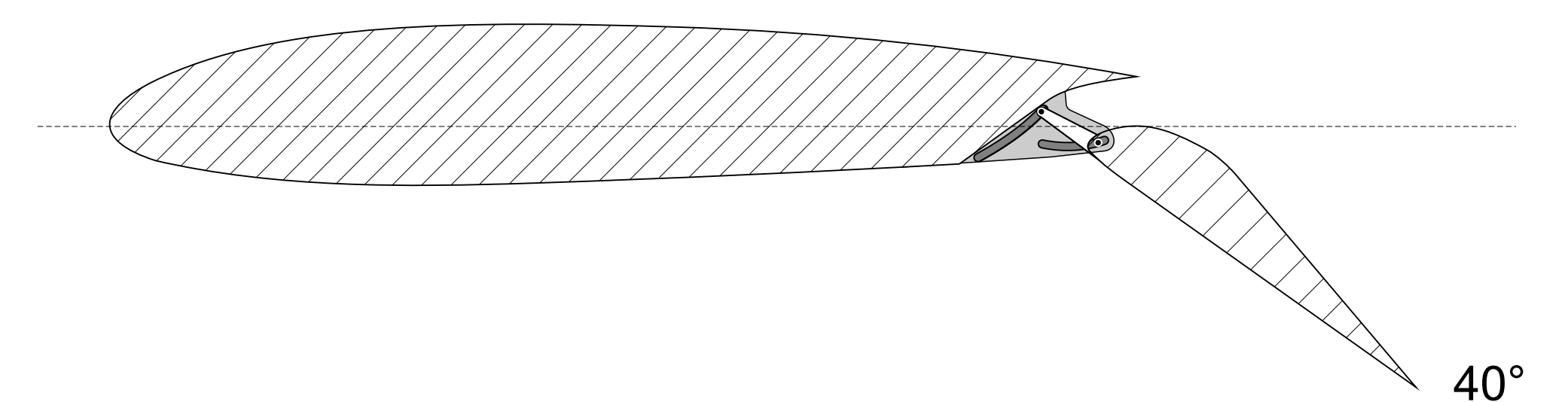
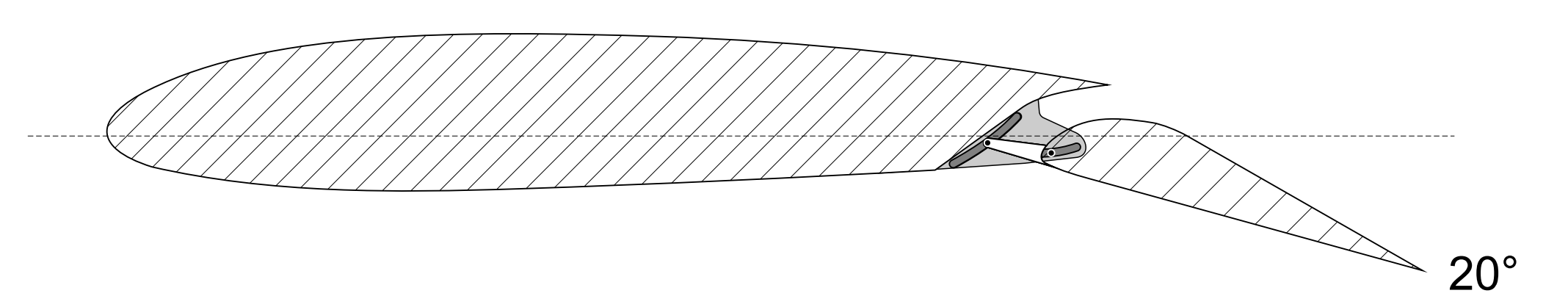

Cessna 180 Skywagon